



5599 Highway 31 West
Portland, TN 37148
(615)325-2774

UHS-10

Pg.1 . TITLE PAGE

Pg.3 . UHS-10 BOM

Pg.2 . UHS-10

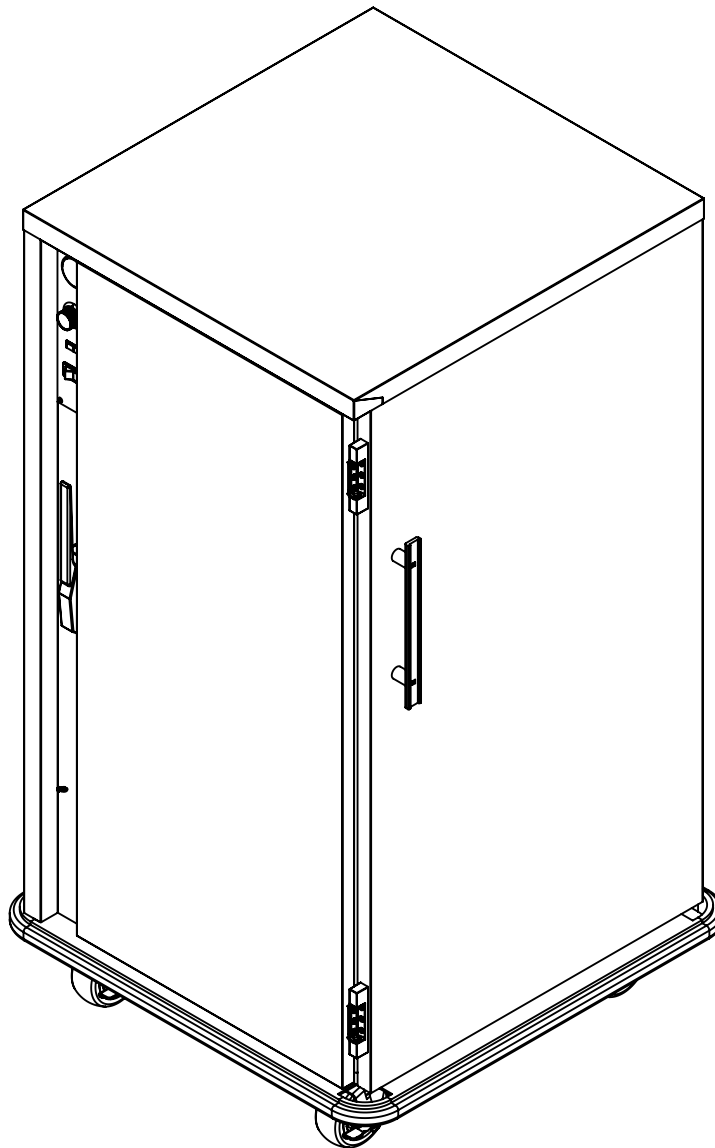

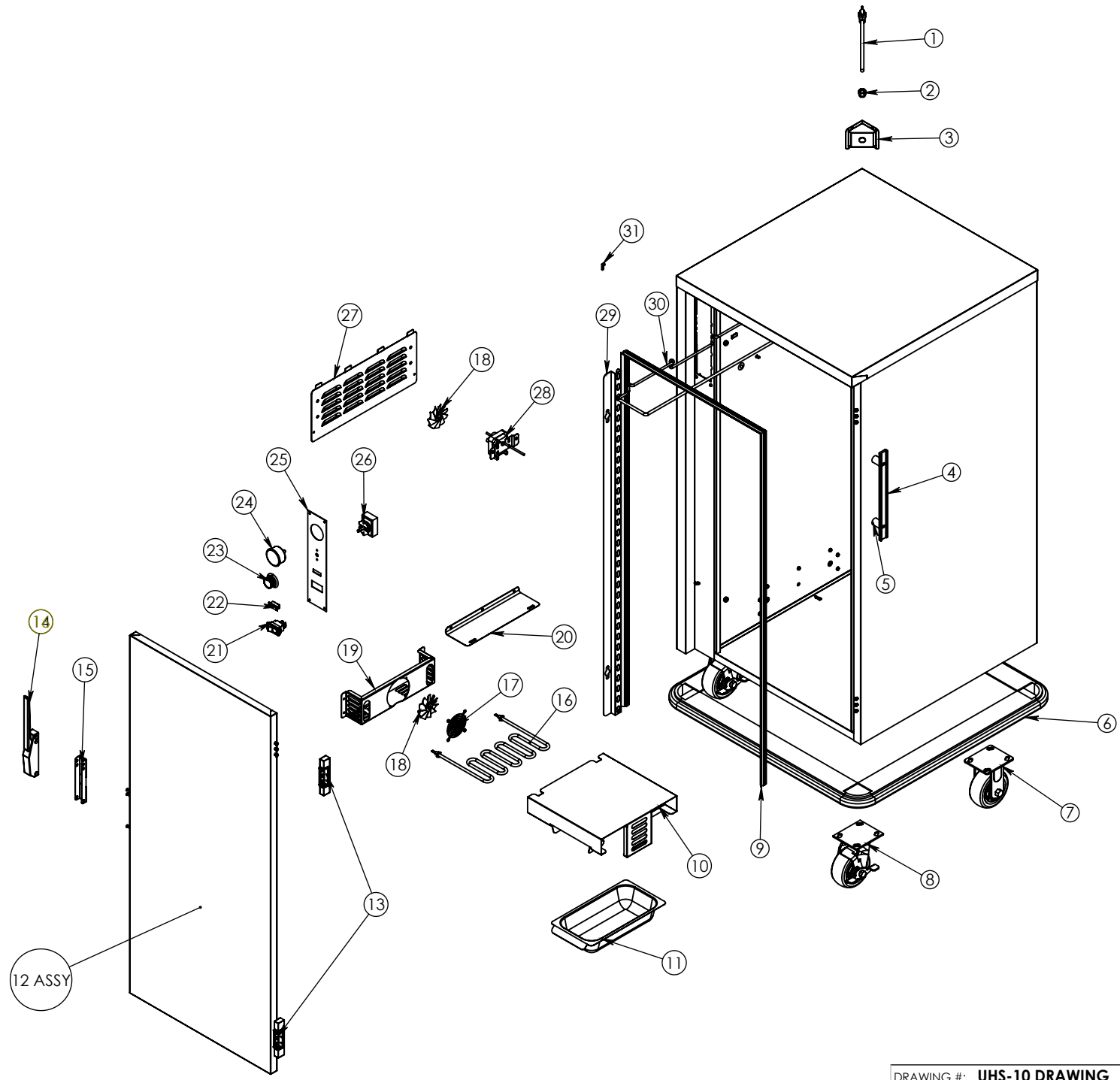

DRAWING #: UHS-10 DRAWING	
DESCRIPTION: UNIVERSAL SERVER	
DRAWN BY: OH	LAST SAVED BY: ohooks

ITEM NO.	QTY.	PART NO.	DESCRIPTION
1	1	CRDSET10-115	CORD 12' 115V 5-15P 14GA 3WR 15AMP
2	1	BSH STRN 3	STRAIN RELIEF FOR 15 AMP CORD
3	1	69729	HUMI TRI-CORD BRCKET DD .672X .750
4	2	HDL-125-AL	HANDLE PUSH ALUMINUM 12.5" LONG
5	4	SPCR125X.330	HANDLE SPACERS FOR HDL 21 AND 12.
6	1	Z-200-1564	UHS-10 BUMPER ASSY
7	2	CSTR 52-R-PPF	CASTER 5" RIGID EZ ROLL POLY
8	2	CSTR 52-SB-PPF	CASTER 5" SWIVEL BRAKE EZ ROLL POLY
9	1	GSKT-D-51X23-375	SILICONE DR GASKT D 51X23.375 3S
10	1	58408	HUMITEMP TUNNEL ASSEMBLY 12" R.H.
11	1	WATER-PAN-3RD-WHDL	WATER PAN 2.5" X6.75 X
12	1	Z-301-3891(INCLUDES 13-15)	UHS-10 DOOR ASSY EDG/EDG RH
13	2	HNG-214	DOOR HINGE EDGEMOUNT .875"
14	1	LTH-DR	DOOR LATCH EDGEMOUNT STYLE CHROME
15	1	81004	LTH-DR LATCH COVER NSF
16	1	EL1250-120-HT	ELEMENT 1250 WATT 120 VOLT 8" HT
17	1	GRD FAN	FAN GUARD
18	2	BLD FAN AL	FAN BLADE 3" ALUMINUM
19	1	4011	HUMITEMP BLOWER HOUSING
20	1	4041	HUMITEMP BLOWER LID
21	1	SWH RCK E1	SWITCH NON-LT ROCKER 125/250V 20AMP
22	1	LT PLT A-G	INDICATOR LIGHT AMBER GREEN 125V
23	1	KNB H6	KNOB WITH ARROW
24	1	T-METER H1	THERMOMETER 100-220
25	1	CNTRL-PNL-HUMI-TEMP-AL	ALUM PANEL FOR HUMI-TEMP
26	1	T-STAT H1	THERMOMSTAT HEAT CONTRL 90-190 36"
27	1	53454	HUMITEMP LOUVER PANEL W/TABS
28	1	Z-600-6151	MOTOR DUAL SHAFTED 120 VOLT
29	1	53194	UHS-10 UPRIGHT .750 OFFSET
30	20	SLD-UHS245-SS	TRAY SLIDE STAINLESS STEEL UHS
31	2	CLP-AL3-8	CLAMP 3-8" ALUM



DRAWING #: **UHS-10 DRAWING**

DESCRIPTION: **UNIVERSAL SERVER**

DRAWN BY: OH

LAST SAVED BY: ohooks