



5599 Highway 31 West  
Portland, TN 37148  
(615) 325-2774

# PHTT-2DR-6-120V

Pg.1 . TITLE PAGE

Pg.3 . DETAIL

Pg.2 . PHTT-2DR-6

Pg.4 . PHTT-2DR-6 BOM

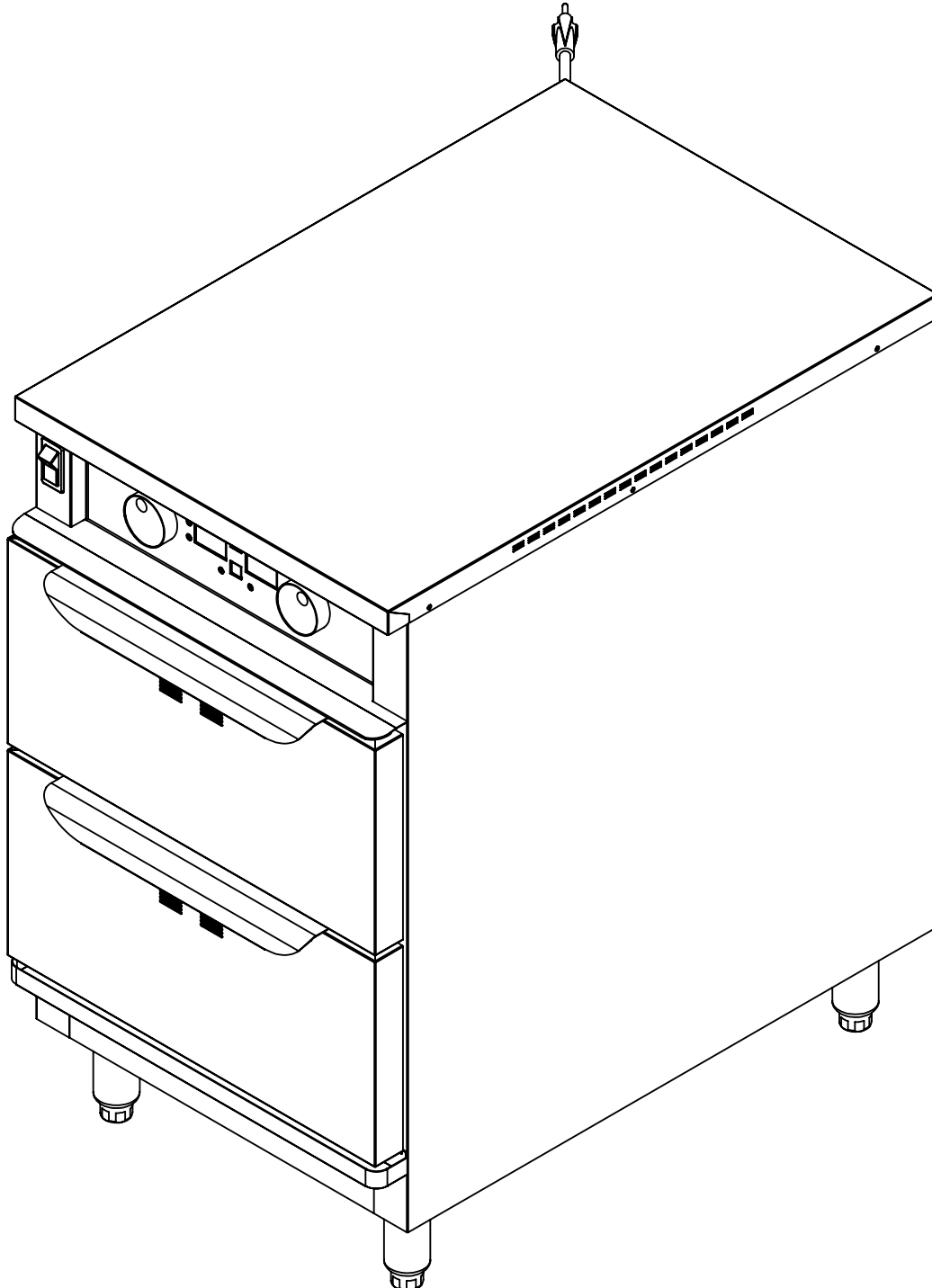

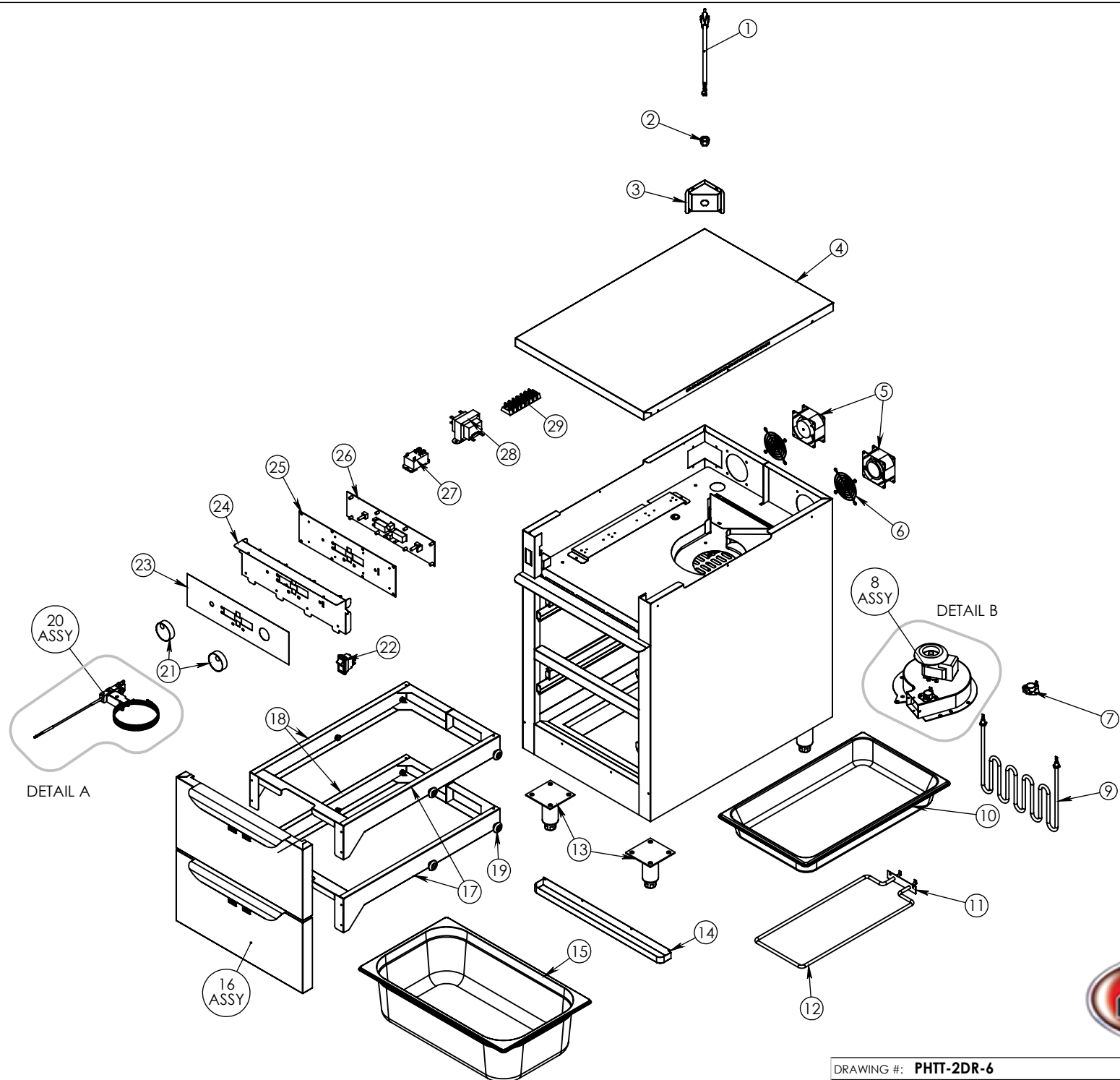

DRAWING #: **PHTT-2DR-6**

DESCRIPTION: **HEATED DRAWER WITH MOISTURE**

DRAWN BY: A.L.

LAST SAVED BY: andrew82

# A

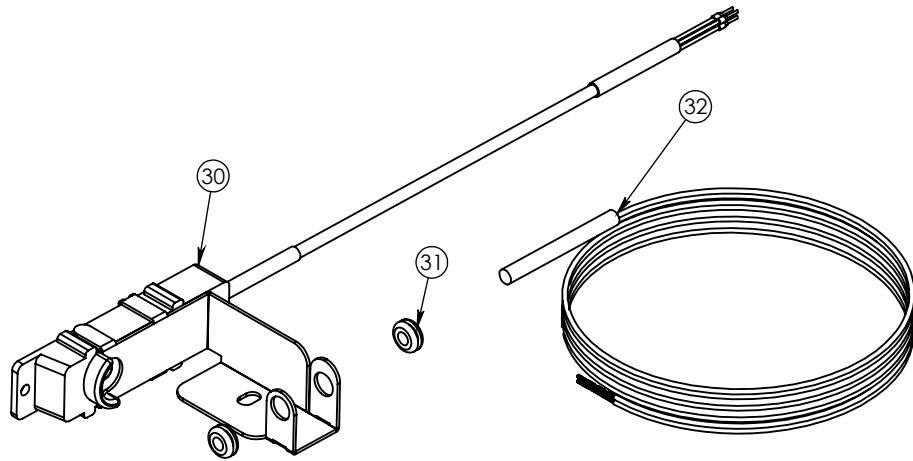

# B

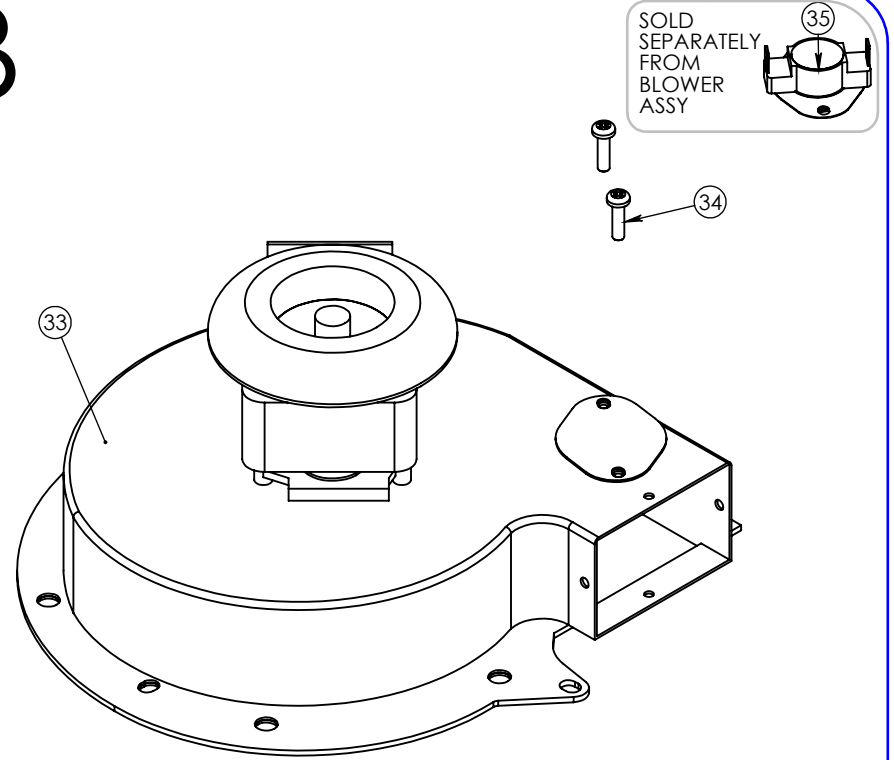

ITEM NO.	QTY.	PART NO.	DESCRIPTION
1	1	CRDSET10-115	CORD 12' 115V 5-15P 14GA 3WR 15AMP
2	1	BSH STRN 3	STRAIN RELIEF FOR 15 AMP CORD
3	1	69729	HUMI TRI-CORD BRCKET DD .672X .750
4	1	27086	HDW-MT-1IN OUTSIDE TOP
5	2	FAN PHTT 115	115V FAN,80 X 80 X 38MM
6	2	GRD FAN	FAN GUARD
7	1	SNAP DISC 210-250	HI-LIMIT SWITCH NC
8	1	Z-600-6647(INLUDES 33-34)	BLWR-120-60S RETROFIT W SNAPDISC
9	1	EL1250-120-HT	ELEMENT 1250 WATT 120 VOLT 8" HT
10	1	PAN 12X20X2.5	FULL SIZE SS PAN, 2-1/2" DEEP
11	1	GSKT HLC	SILICONE SPONGE 1/16" D/C W/PSA
12	1	EL350-120-A16	ELEMENT 350 WATT 120 VOLT 16" A
13	4	Z-600-4755	LEGS STAINLESS STEEL ADJ 4"-6"
14	1	82504	HDW-MT-1IN DRIP TROUGH
15	2	PAN 12X20X6	FULL SIZE SS PAN 6" DEEP
16	2	Z-301-5045(INLCUDES 17-19)	PHTT-2W6 DOOR W/DRW ASSY VNT HWF
17	2	83502	PHTT-2DR-6 SIDE PAN HOLDR RIGHT
18	2	83503	PHTT-DR-6 SIDE PAN HOLDR LEFT
19	8	RLR CON SS	CONVEX ROLLER SS 1-1/16OD
20	1	Z-800-2042(INCLUDES 30-32)	PHTT SENSOR MOUNT PLATE ASSY
21	2	KNB PHTT	KNOB, DIMPLE TURN
22	1	SWH RCK EI	SWITCH NON-LT ROCKER 125/250V 20AMP
23	1	CNTRL PNL PHTT	OVERLAY FOR CLYMAE IQ (PHTT)
24	1	82498	HDW-MT-1IN CONTROL PANEL
25	1	80030	CNTRL PANEL PRECISE HUMITEMP
26	1	CNTRL BRD-PHTT STD	CONTROL BOARD FOR STANDARD PHTT
27	1	RLY 30AMP DPDT	30AMP PANEL MOUNT RELAY,2 POLE 120V
28	1	TRNS-240-120-40VA	TRANSFORMER 240V-120V 40 VA
29	1	TRM BLK RTH	TERMINAL BLOCK -6 POLES
30	1	Z-600-3850	PHTT SENSOR NO T PROBE
31	2	GRMT-HT-3-16	SILCONE GROMMET 3/16ID X 7/16OD
32	1	THERMISTOR-PROBE	THERMISTOR PROBE NTC
33	1	BLWR-120-60S	BLOWER ASSY 120V, 60HZ SHORT STACK
34	4	S8-32X10 CTS	SCRW 8-32x5/8 PH CUT 410
35	1	SNAP DISC 150-130	COOL DOWN SNAP DISC F150 OPEN RISE



DRAWING #: **PHTT-2DR-6**

DESCRIPTION: **UNIVERSAL SERVER**

DRAWN BY: A.L.

LAST SAVED BY: andrew82