



5599 Highway 31 West  
Portland, TN 37148  
(800) 222-4393

# P-120-2

Pg.1 . TITLE PAGE

Pg.3 . P-120-2 BOM

Pg.2 . P-120-2 EXPLODED

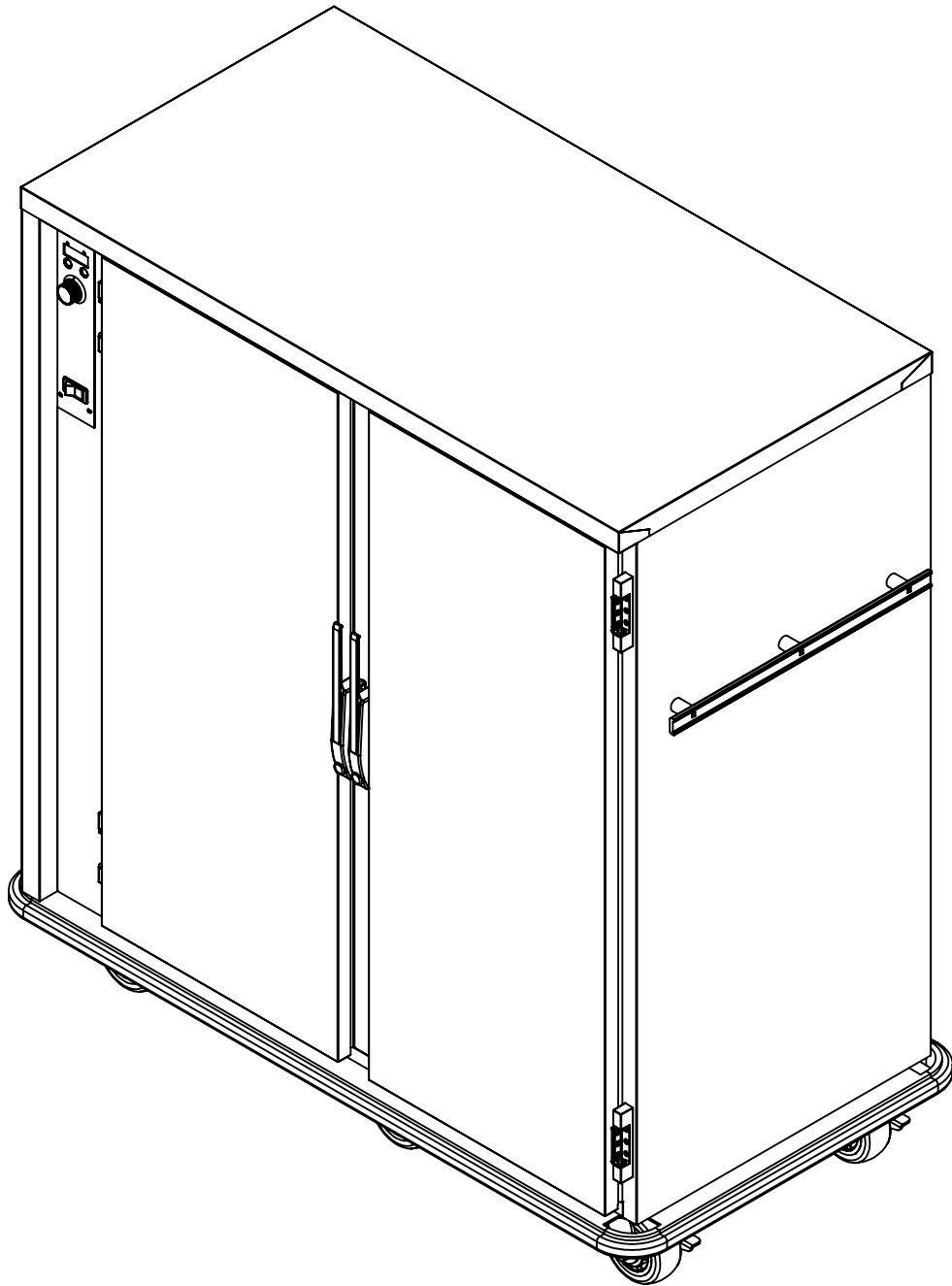

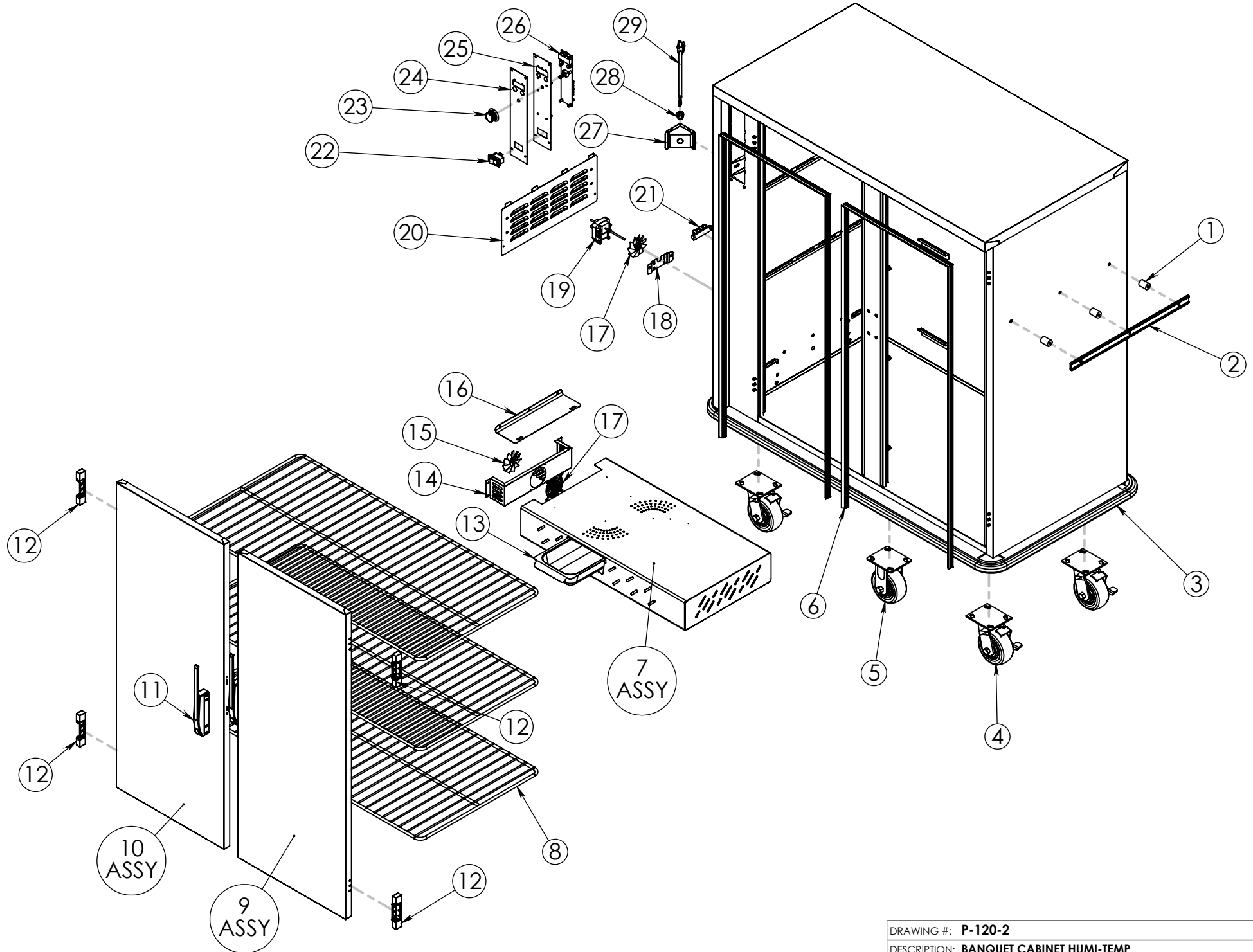

DRAWING #: **P-120-2**

DESCRIPTION: **BANQUET CABINET HUMI-TEMP**

DRAWN BY: DP

LAST SAVED BY: dplodzien

ITEM NO.	QTY.	PART NO.	DESCRIPTION
1	6	SPCR125X.330	HANDLE SPACERS FOR HDL 21 AND 12.
2	2	HDL-215-AL	HANDLE PUSH AL 21.5
3	1	Z-200-1002	BUMPER ASSEMBLY
4	4	CSTR 52-SB-PPF	CASTER 5" SWIVEL BRAKE EZ ROLL POLY
5	2	CSTR 52-R-PPF	CASTER 5" RIGID EZ ROLL POLY
6	2	GSKT-D-48-062X19-625	SILICONE DR GASKET D 48.062X19.625
7	2	Z-600-1252	WATER PAN TUNNEL ASSEMBLY
8	3	SHLF-P120	SHELF 22.25X44.25"
9	1	Z-301-3994 (INCLUDES 11 & 12)	DOOR ASSEMBLY EDG/MAG RH
10	1	Z-301-3995 (INCLUDES 11 & 12)	DOOR ASSEMBLY EDG/MAG LH
11	2	LTH MAG	DOOR LATCH EDGEMOUNT CHROME MAGNTIC
12	4	HNG-214	DOOR HINGE EDGEMOUNT .875"
13	1	WATER-PAN-3RD-WHDL	WATER PAN 2.5" X6.75 X
14	1	5345	HUMITEMP BLOWER HSING
15	2	BLD FAN AL	FAN BLADE 3" ALUMINUM
16	1	4041	HUMITEMP BLOWER LID
17	1	GRD FAN	FAN GUARD
18	1	80610	BRACKET MOTOR MNT FOR BAY MTR
19	1	MTR BY120 92	MOTOR DUAL SHAFTED 120 VOLT
20	1	53454	HUMITEMP LOUVER PANEL W/TABS
21	1	TRM 4QC	TERMINAL BLOCK 4QC
22	1	SWH RCK E1	SWITCH NON-LT ROCKER 125/250V 20AMP
23	1	KNB H6	KNOB WITH ARROW
24	1	CNTRL PNL T-STAT V-G	OVERLAY, HUMI-TEMP IEC VERTICAL
25	1	81388	ELECTRONIC T-STAT RCK E1 SWITCH
26	1	T-STAT ELE 2	ELEC THERMO HEAT CNTRL VERTICAL IEC
27	1	69729	HUMI TRI-CORD BRCKET DD .672X .750
28	1	BSH STRN 3	STRAIN RELIEF FOR 15 AMP CORD
29	1	CRDSET10-115	CORD 12' 115V 5-15P 14GA 3WR 15AMP

DRAWING #: **P-120-2**

DESCRIPTION: **BANQUET CABINET HUMI-TEMP**

DRAWN BY: DP

LAST SAVED BY: dplodzien